

Table of Contents

	<u>Pages</u>
General Notes	2
Cabinet Construction and Maintenance	3
Sample and Display Information	4
Single and Double Full Height Door Cabinets	5
False Drawer Front and Sink Bases	6
Base Cabinets with Drawers	7
Corner Cabinets	8-9
Drawer Banks	9
Wall Cabinets	10-11
Side Grill Cabinets	11
Grill Cabinets	11
Fillers and Panels	12
Finished End Cabinets	12
Stand Alone Grill Centers	13-17
Access Doors for Block	18
Access Doors with Drawers for Block	19
Under grill access doors for Block	20
Drawer Banks for Block	20
Hood Enclosures and Chimney covers	21
Order Forms	22
Dealer Registration	23
Warranty Information	24
Price Sheet	25



General Information

23330 Harborview road
Punta Gorda, FL 33980
Phone 941-875-9900

Quality Control

Lifestyle Cabinets goes through a 5 step process for quality control. All our wood is pre-selected and goes through a visual inspection prior to entering the production area. Once in production, the wood is cut to size and examined for any flaws. Then, each aluminum panel is inspected prior to powder coating and again after. Before assembly starts, all parts are re-inspected again and then assembled. Finally, our QC inspector looks over every detail including weld, powder coating, wood and inserts to ensure there are no flaws in our product. We then crate everything - ensuring there is no damage and the packaging is secure and vital areas are fully covered.

Ordering/ Delivery

Once Lifestyle receives an order form, we will input information into our system and fax an invoice of your order that will need to be signed and faxed back. Please look over the invoice thoroughly to insure no mistakes have been made on our part or your part. Once the invoice is signed, all products will be made as per invoice. No returns or alterations can be made once invoice is in production. Lifestyle will take no responsibility for any mistakes on a signed invoice. If Lifestyle should ship a product that was not on the invoice or is wrong (due to our error) we will re-make and ship at our expense.

All invoices must be paid at time of order. Production will start once payment in full is received.

Lifestyle will inform you of the time frame for custom orders, generally being shipped within 21 to 30 working days.

Damaged claims and replacement parts will ship in 5 working days.

Tips and Help

Always show customers your door sample(s) and have them sign off on door style and wood variation.. Ipe (pronounced e-pay) is a consistent wood, however there are always some variations in natural products. Lifestyle will not take returns for normal variations of wood. We select our wood very carefully to limit the variation on each job. If there is a defect in the wood, we will replace the wood or the door.



Cabinet Construction

Lifestyle cabinets has worked on perfecting this system of cabinetry since 2004. All our cabinets are constructed from powder coated .090 aluminum. All joints are either riveted or welded depending on structural requirements and aesthetics. The floors and backs are a polymer designed for outdoor use and are black in color. All additional hardware is aluminum or stainless steel. Drawers are constructed from polymer to ensure a long lasting drawer system. Ipe (pronounced e-pay) is used for cabinet doors and drawer fronts. Ipe is one of the hardest woods available, for outdoor use it is rated for 50-75 years. Ipe also has the same fire rating as concrete. Lifestyle selects wood used on our cabinets very carefully. When putting an order together we lay out all the wood required for the entire invoice prior to assembling the first part. This ensures a uniform look throughout the project. All parts go through a quality control check and are fully assembled prior to shipping.

Note: All interior cabinet dimensions are 2 inches smaller than the overall outside dimension. Sink bases have a bend at the top of the cabinet for structure reducing the overall width of the top cabinet opening for the sink by another 1 1/2 inches.

Maintenance

Ipe requires some maintenance. We recommend using linseed oil or teak oil on a regular schedule. If cabinets are in direct sunlight for the better part of the day we recommend oiling them every 4 to 6 weeks. If the cabinets are covered and not in any direct sunlight we recommend oiling every 8 to 12 weeks. Every time oiling is done, simply clean the metal insert with a dry rag to remove any built up dirt on the surface.

Cleaning

When cleaning cabinets open the doors and remove any large debris. Use a water hose or pressure washer and spray the interior and exterior of the cabinet well and allow water to drain out the bottom. Drying is usually not necessary as the water will drain from the cabinets. Allow wood to dry for about 2 hours and re-oil the wood.



Sample and Display Orders

23330 Harborview Road
Punta Gorda, FL 33980
Phone 941-875-9900

Sample Doors

Sample door sets include 5 doors, mounted on standard powder coated aluminum, with Ipe and standard Inlays. Doors measure 15 inches by 15 inches. Sample doors are \$250.00 for the set of five. Lifestyle will deduct the cost of the samples at a rate of 10% of future invoices or a maximum of \$250.00 per invoice.

To be an eligible dealer a minimum of 1 set of sample doors is required.

Display Orders

Display orders will be priced at a reduced cost. The corporate office will determine the cost of displays based on the amount of displays purchased. All display orders must be approved by the corporate office and signed off on, prior to fabrication by corporate and your local representative.

A Lifestyle representative will confirm the installation of display. If display is removed from showroom or is not in full working order for at least one year, the cost of the display will be billed to original purchaser .

Builder's Models

Lifestyle will give a discount of 15% on all approved model homes. We will also give the same discount for a builder's or designer's showroom. Orders must be signed off by your local representative and corporate headquarters. Builder/designer information and site location must be included in description on order form along with estimated future projects per year. A minimum of \$10,000.00 per year in estimated purchases will be required to receive discount.



Product Description

23330 Harborview Road
Punta Gorda, FL 33980
Phone 941-875-9900

Single Full Height Door Cabinets

Minimum 15 inch charge

All cabinets are 34 1/2" tall with 4 1/2" toe kick hinged left or right

Base cabinet full height single door

Maximum size 21 inches

Toe kick is included in price

FHD24

FHD 27

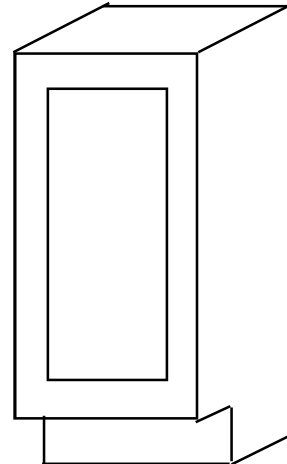

Double Full Height door Cabinets

Minimum 24 inch

All cabinets are 34 1/2" tall with 4 1/2" toe kick hinged left or right

Base cabinet full height Double door

All cabinets 24 inches or longer will be double door.

Minimum size 24 inches

Maximum size of 48 inches

Toe kick is included in price

FHD24

FHD 27

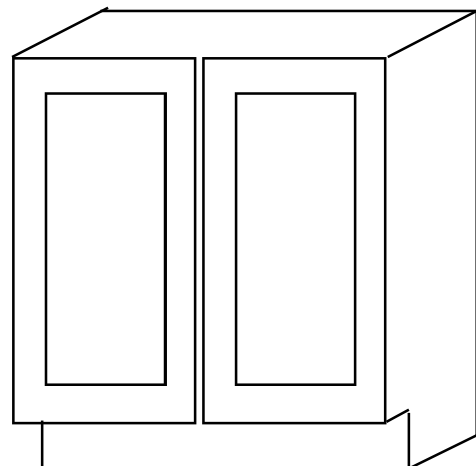



Product Description

23330 Harborview Road
Punta Gorda, FL 33980
Phone 941-875-9900

False Drawer Fronts and Sink Bases

Minimum 15 inch charge

Many customers prefer not to have working drawers, however like the aesthetics of the false drawer front. We offer these in a variety of sizes and they are used for sink bases as well.

All cabinets are 34 1/2" tall with 4 1/2" toe kick hinged left or right with false drawer front.

Maximum size 21

Toe kick is included in price

SB24

SB27

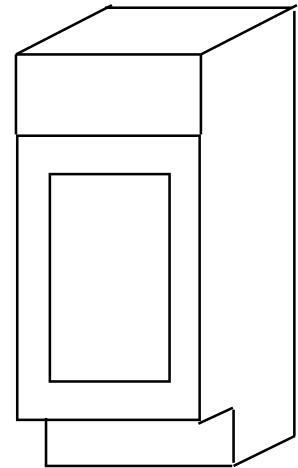

False Drawer Fronts and Sink Bases

Minimum 24 inches

All cabinets are 34 1/2" tall with 4 1/2" toe kick

Base cabinet Double Door False Drawer Front

Base cabinet full height Double door

All cabinets 24 inches or longer will be double door

Minimum size 24 inches

Maximum size of 48 inches

Toe kick is included in price

SB24

SB27

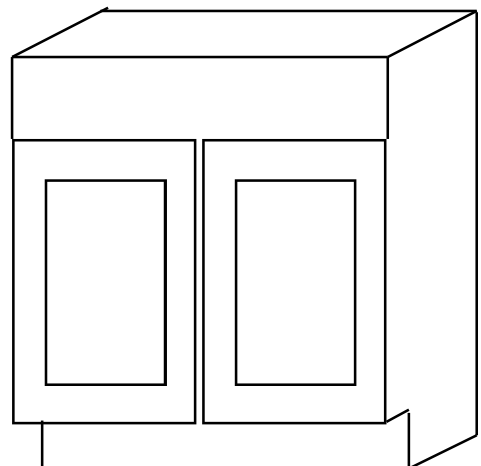



Product Description

23330 Harborview Road
Punta Gorda, FL 33980
Phone 941-875-9900

Base Cabinets Working Drawers

Single Door Single Drawer

Minimum 15 inch charge

All cabinets are 34 1/2" tall with 4 1/2" toe kick single door hinged left or right with working drawer.

Maximum size of 21 inches
Toe kick is included in price

B24

B27

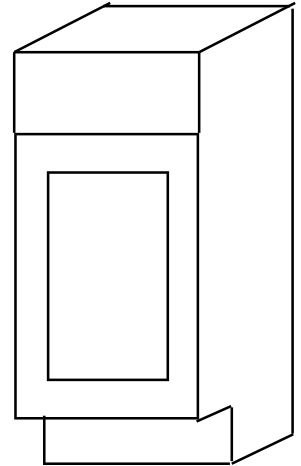

Double Door Single Drawer

Minimum 24 inches

All cabinets are 34 1/2" tall with 4 1/2" toe kick double door and working drawer.

Base cabinet full height Double door
All cabinets 24 inches or longer will be double door

Minimum size 24 inches

Maximum size of 48 inches

Toe kick is included in price

B24

B27

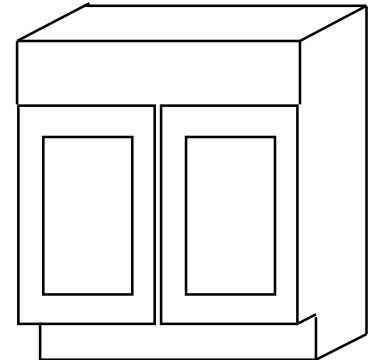

Double Door Double Drawer

Minimum 30 inches

Maximum size of 48 inches

Toe kick is included in price

BDD24

BDD27

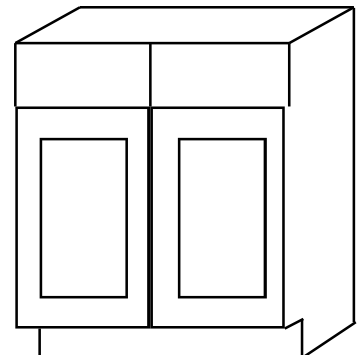



Product Description

23330 Harborview road
Punta Gorda, FL 33980
Phone 941-875-9900

Corner cabinet

All cabinets are 34 1/2" tall and 24 inches deep with 4 1/2" toe kick can be ordered left or right.

BBR24 24 inch deep cabinet
BBR27 27 inch deep cabinet

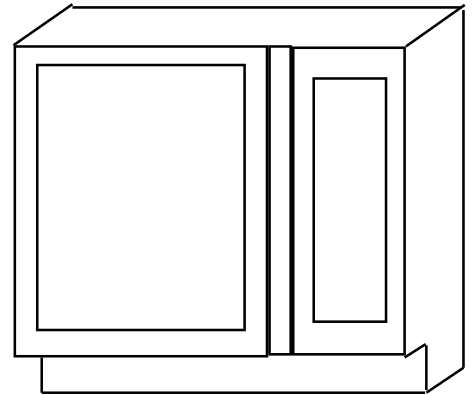

BBR

BBL24 24 inch deep cabinet
BBL27 27 inch deep cabinet

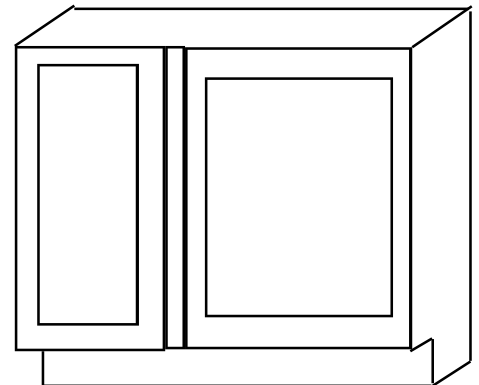

BBL

Diagonal base cabinets

All cabinets are 34 1/2" tall with 4 1/2" toe kick. Diagonal base cabinet for inside corners.

A= 36 B= 24 to meet 24 inch deep cabinets

BDC24

A=39 B=27 to meet 27 inch deep cabinets

BDC27

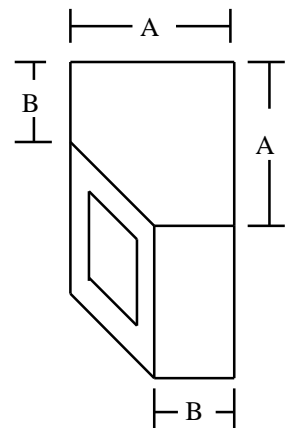



Product Description

23330 Harborview Road
Punta Gorda, FL 33980
Phone 941-875-9900

Base diagonal cabinet 45 degree
For use as transition from wall to peninsula.

For 24 inch deep cabinet **DIB4524**

For 27 inch deep cabinets **DIB4527**

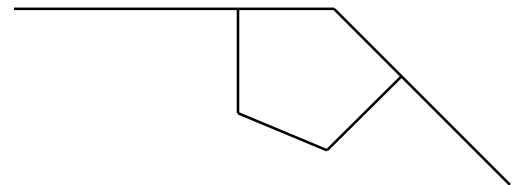
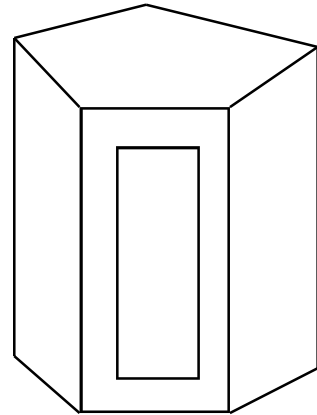

Top View

Drawer Banks

Drawer banks are finished in Ipe fronts polymer constructed drawer or aluminum for bigger drawers
Add per drawer one drawer is included in price.

DB324 DB327
DB424 DB427

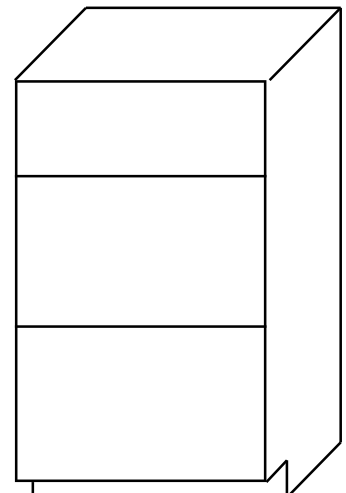



Product Description

23330 Harborview Road
Punta Gorda, FL 33980
Phone 941-875-9900

Wall cabinets

Single door cabinets available in 30", 36", 42" in tall hinged right or left. **All cabinets are 14 inches deep**

Maximum 21 inches

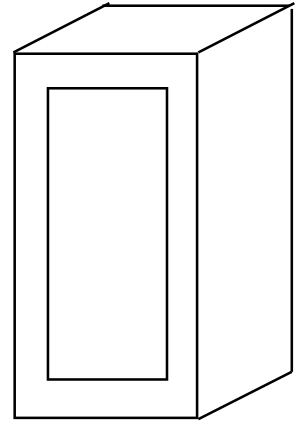

Double door cabinets available in 30", 36", 42" in tall . **All cabinets are 14 inches deep**

Minimum size 24 inches

Maximum size of 48 inches

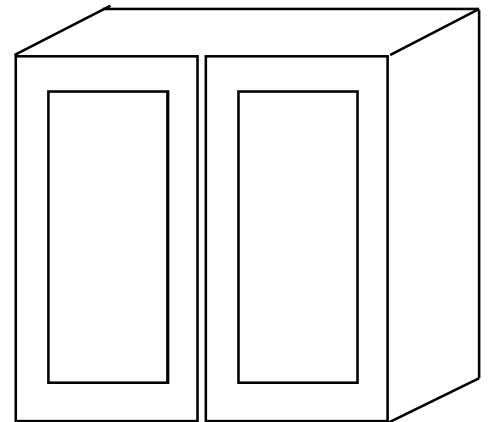



Product Description

23330 Harborview road
Punta Gorda, FL 33980
Phone 941-875-9900

Diagonal Wall Cabinets

Diagonal wall cabinets finish at 26 inches from corner of wall

30 inch tall WDC30

36 inch tall WDC36

42 inch tall WDC42

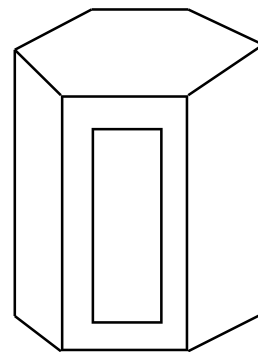

Side Grill Cabinets

Side grill cabinets are 30 inches tall with a 4 1/2 inch toe kick and come with trim kit one piece the width of the cabinet and 2 pieces 5 inches by 10 inches.

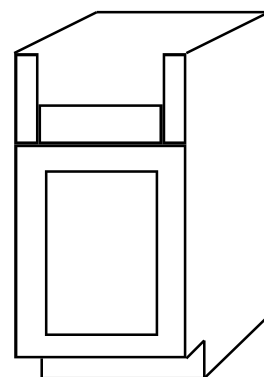

Grill Cabinets

Grill cabinets are 34 1/2 inches tall with 4 1/2 inch toe kick and come with trim kit one piece the width of the cabinet and 2 pieces 5 inches by 10 inches.

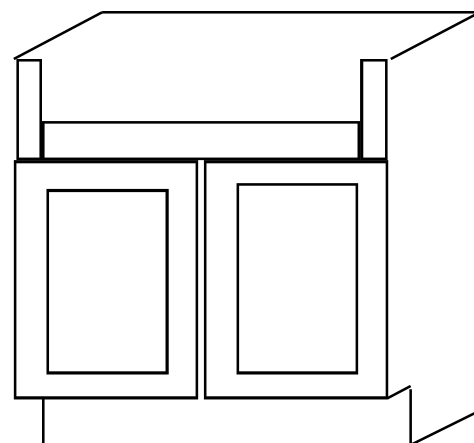



Product Description

23330 Harborview Road
Punta Gorda, FL 33980
Phone 941-875-9900

Fillers and Panels

Base and wall fillers are 3/4 inch thick solid Ipe. Base fillers do not have a toe kick included. All pieces are finished with 4 sides with 1/4 inch bevel.

Base / Wall filler 3 inches wide 30 inches tall	BF330
Base/ Wall filler 5 inches wide 30 inches tall	BF530
Base/ Wall filler 3 inches wide 36 inches tall	BF336
Base/ Wall filler 5 inches wide 36 inches tall	BF536
Base/Wall filler 3 inches wide 42 inches tall	BF342
Base/Wall filler 5 inches wide 42 inches tall	BF542

Base Transition Fillers

Base transition fillers are for use when transitioning from 24 inch deep cabinets to 27 inch deep cabinets. On a straight run we typically use these fillers for grills the require a deeper cabinet and for aesthetics.

30 X 5 out 3 inches and over 3 inches	DF30
---------------------------------------	------

Toe kick 96 inches long 4 1/2 inches tall	TRK8
---	------

All base cabinets include toe kick. Toe kick will be shipped in useable lengths for job requirements.

Trim pieces for use when fully covering sides or back with Ipe as a bottom and top trim piece.

Trim 2 1/2 inches tall 30 inches long	T30
Trim 2 1/2 inches tall 42 inches long	T42
Trim 2 1/2 inches tall 96 inches long	T96

Finished End Panels

All finished end panels are attached to powder coated aluminum with 3/4 inch Ipe with 1/4 inch bevels on two long edges. Suggest including 2 pieces T30 with purchase.

Finished end panel 34 /12 inches tall All Ipe	FEP
---	-----

Finished end panel 34 /12 inches tall Ipe with decorative metal insert

FMP

Finished Back Panels

All finished back panels are shipped loose pieces and should be attached to the back of the cabinets from the inside of cabinet or attached to Dura rock or similar material first and then attached to the Back of cabinet from the inside of the cabinet

	<u>All Ipe</u>	<u>Ipe W/Metal</u>
30 inches tall	FBP30	FMP30
36 inches tall	FBP36	FMP36

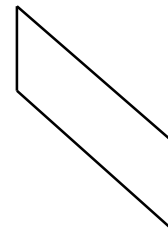
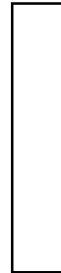

FMP

FBP

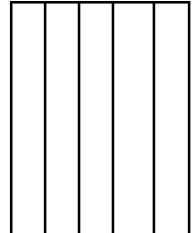
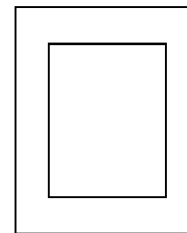

FBP

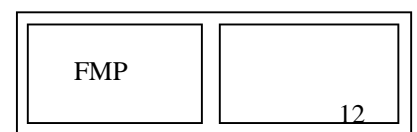
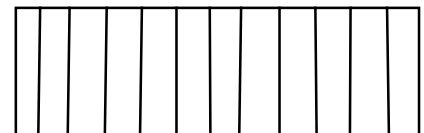



Product Description

23330 Harborview Road
Punta Gorda, FL 33980
Phone 941-875-9900

48 inch stand alone grill center

This grilling center fits 30 inch grill with two 9 inch cabinets on either side. Aluminum frame construction powder coated with all doors covered in Ipe with your choice of standard insert. Grill sold separately. Perfect for smaller areas.

Approximate weight with grill 225 pounds

If wrapping in Ipe add 42 pounds per side and 84 pounds for back

SG48

Please refer to previous page when ordering for options.

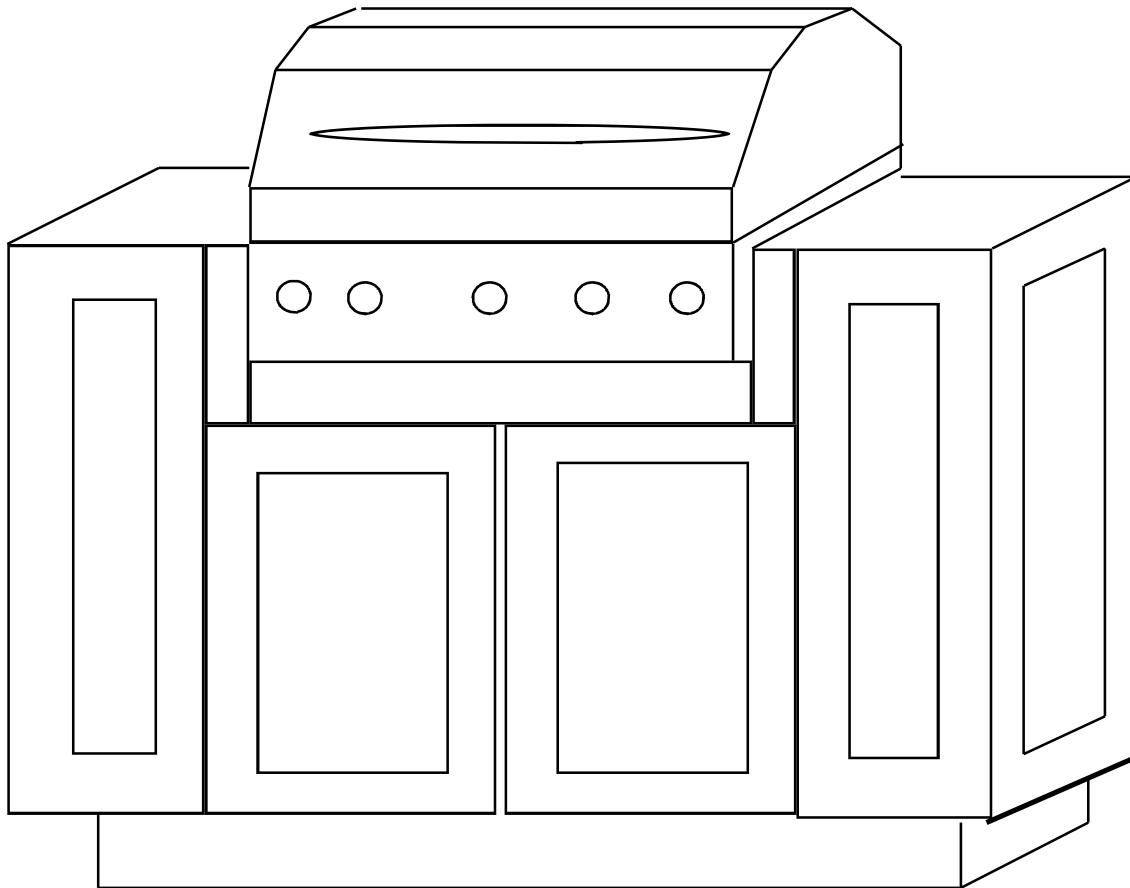



Product Description

23330 Harborview Road
Punta Gorda, FL 33980
Phone 941-875-9900

72 Inch Stand Alone Grill Center

This grilling center fits 30 inch grill with two 21 inch cabinets on either side. Aluminum frame construction powder coated with all doors covered in Ipe with your choice of standard insert. Grill sold separately. Perfect for smaller areas.

Approximate weight with grill 350 pounds

SG72

Please refer to stand Alone Grill Options Page when ordering

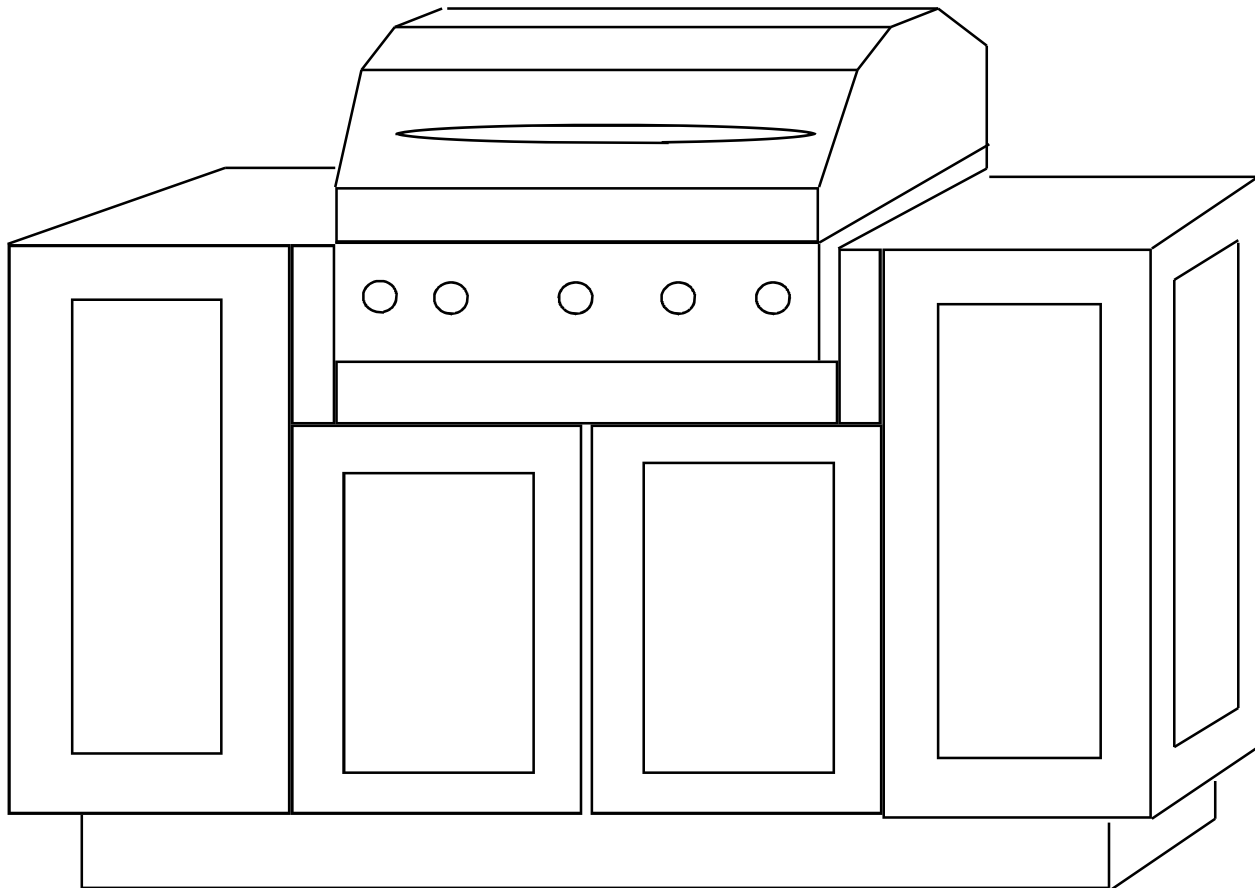



Product Description

23330 Harborview Road
Punta Gorda, FL 33980
Phone 941-875-9900

72 Inch Stand Alone Grill Center With 36 Inch Grill

This grilling center fit 36 inch grill with two 18 inch cabinets on either side. Aluminum frame construction powder coated with all doors covered in Ipe with your choice of standard insert. Grill sold separately. Perfect for smaller areas.

Approximate weight with grill 600 pounds

SGR72

Please refer to Stand Alone Grill Options Page when ordering

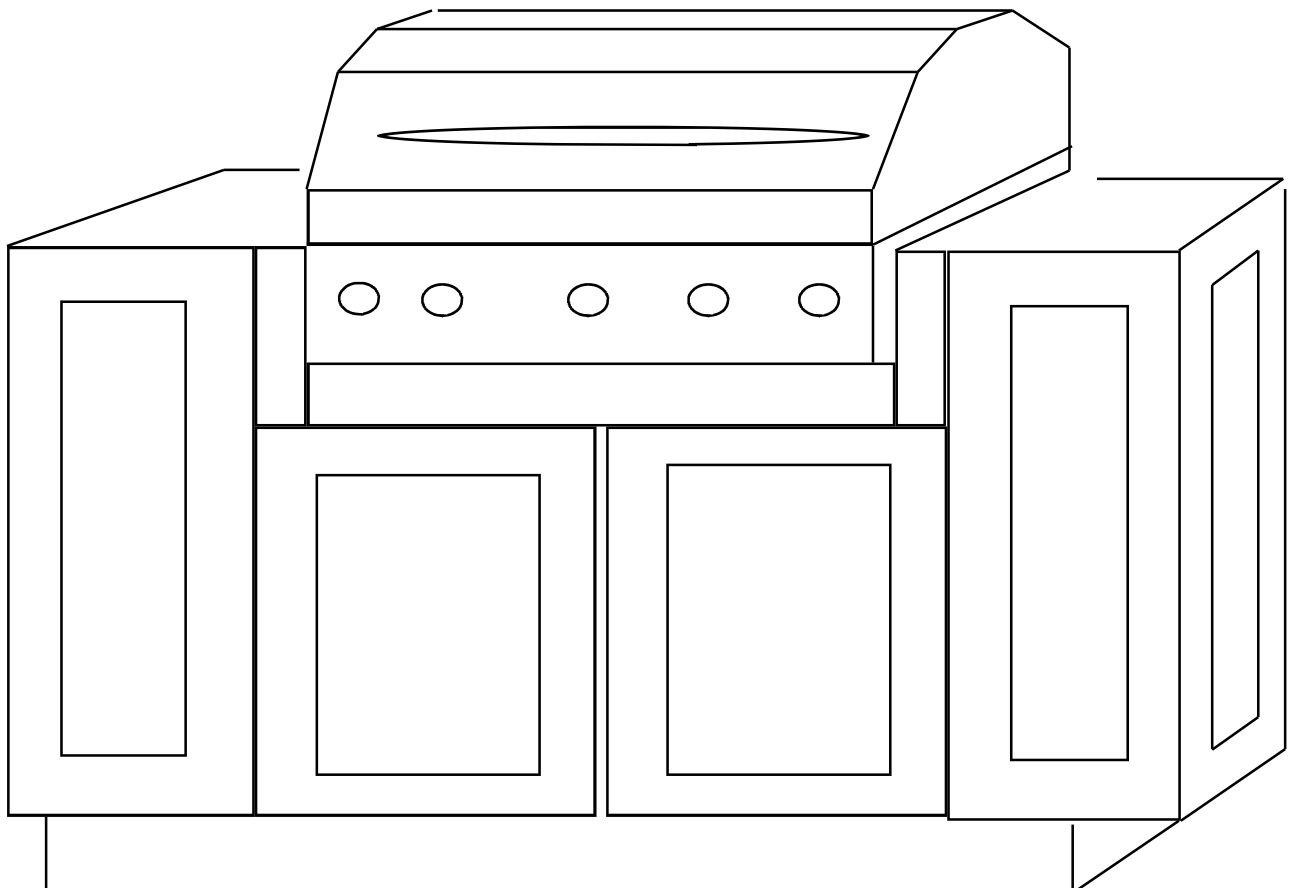



Product Description

23330 Harborview road
Punta Gorda, FL 33980
Phone 941-875-9900

96 Inch Stand Alone Grill Center

This grill center fits 30 inch grill and comes with one large 32 inch cabinet and a refrigerator area. Aluminum powder coated frame construction with doors covered in Ipe and your choice of standard inserts. Sides and back are powder coated aluminum standard.

Approximate weight with grill 600 pounds

SG96

Please refer to Stand Alone Grill Options page when ordering

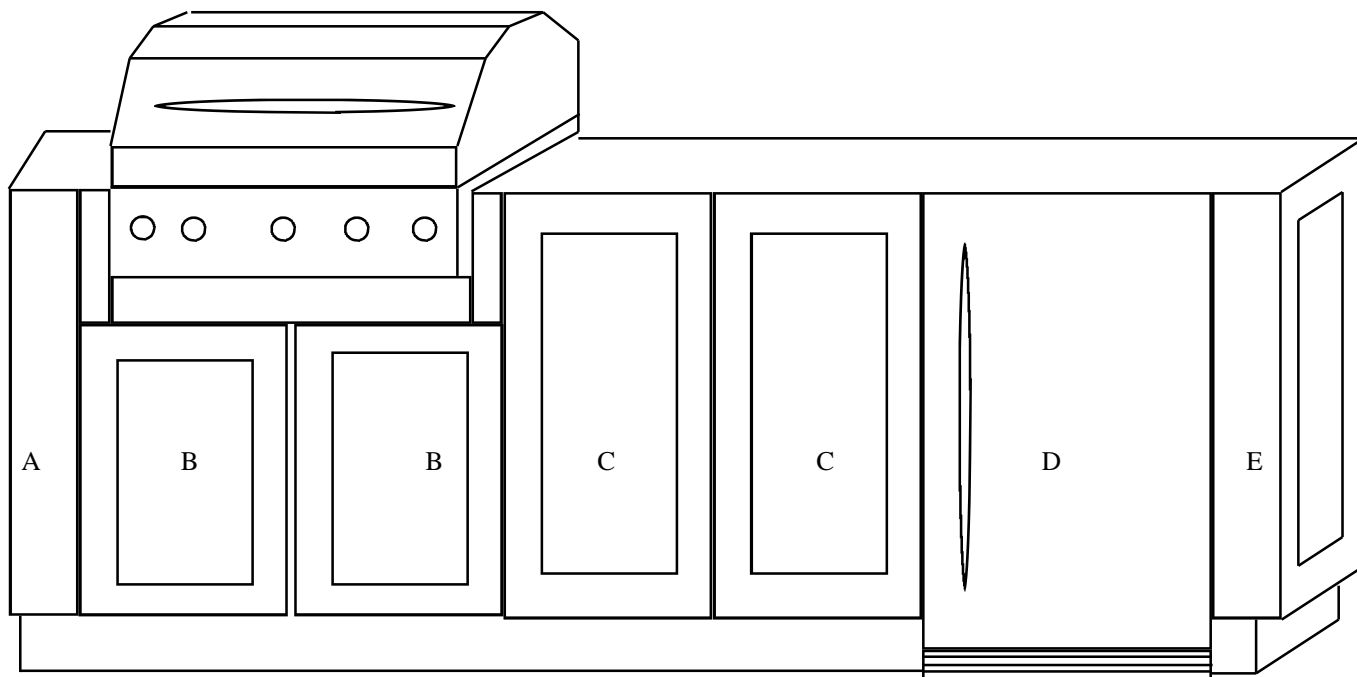

96 inches long A= 5 inches B= 30 inches C= 32 inches D= 24 refrigerator E= 5 inches



Product Description

23330 Harborview road
Punta Gorda, FL 33980
Phone 941-875-9900

96 Inch Stand Alone Grill Center with 36 Inch Grill

This grill center fits 36 inch grill and comes with a large 26 inch cabinet with drawer and a place for refrigerator. Aluminum powder coated frame construction with doors covered in Ipe and your choice of standard inserts. Sides and back are powder coated aluminum standard.

Approximate weight with grill 600 pounds

SGR96

Please refer to Stand Alone Grill Options page when ordering

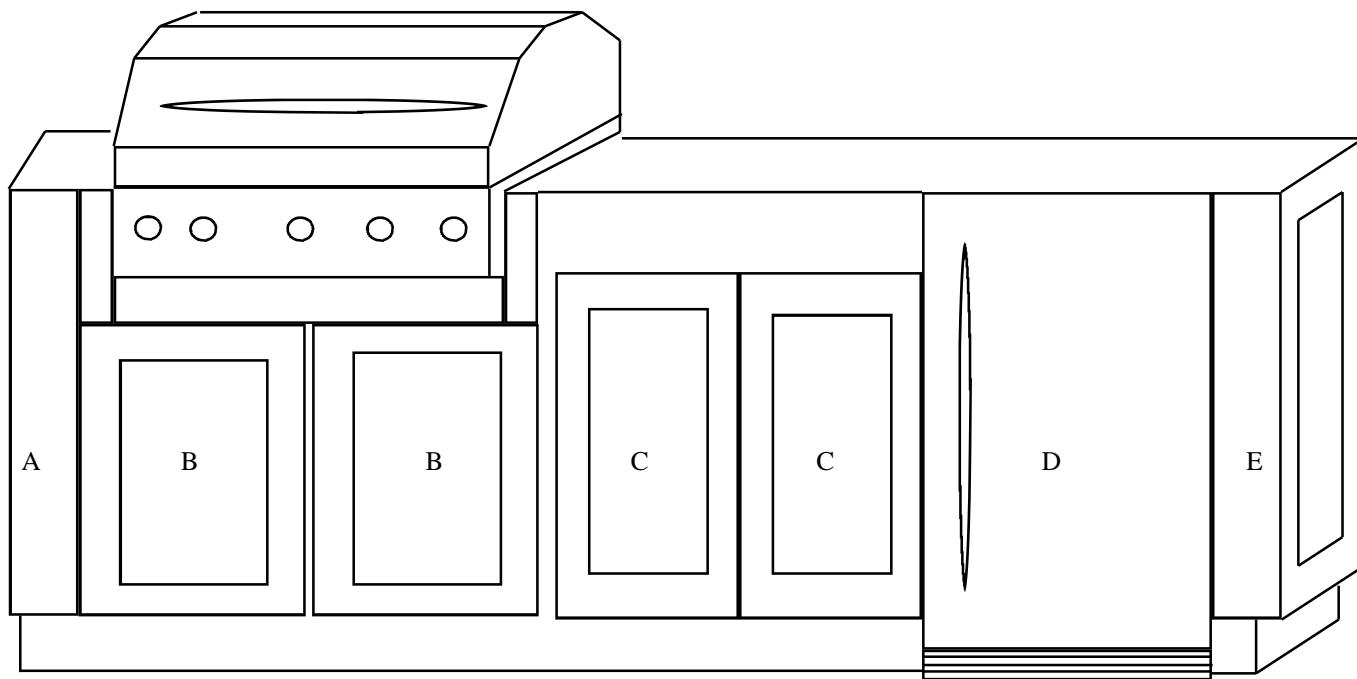

96 inches long A= 5 inches B= 36 inches C= 26 inches D= 24 refrigerator E= 5 inches



Product Description

23330 Harborview road
Punta Gorda, FL 33980
Phone 941-875-9900

Doors and Drawers

Single Access Door

Cut out for wall will be $7/8$ (+/- $1/8$) inch less than outside dimension of door ordered

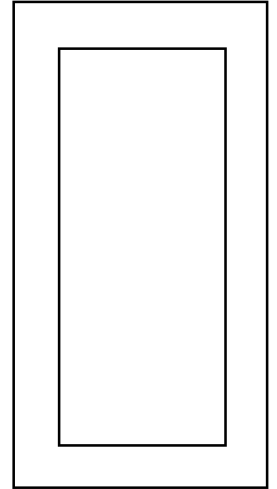

Double Access Door

Cut out for wall will be $7/8$ (+/- $1/8$) inch less than outside dimension of door ordered

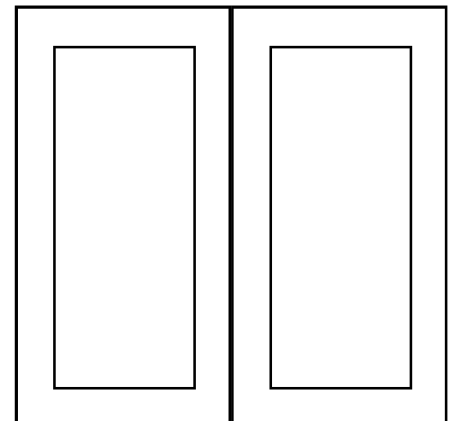



Product Description

23330 Harborview road
Punta Gorda, FL 33980
Phone 941-875-9900

Single Door with drawer

Cut out for wall will be 1 1/2 (+/- 1/4) inch less than outside dimension of door ordered and 23 inches from front of door to back of cabinet

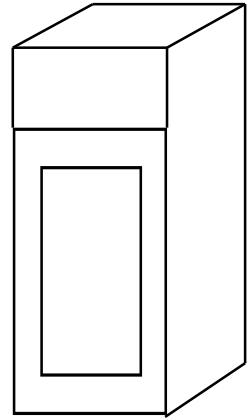

Double Access Door

Cut out for wall will be 1 1/2 (+/- 1/4) inch less than outside dimension of door ordered and 23 inches from front of door to back of cabinet

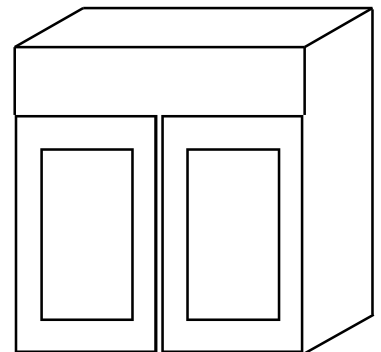

Double Door with Double Drawer

Cut out for wall will be 1 1/2 (+/- 1/4) inch less than outside dimension of door ordered and 23 inches from front of door to back of cabinet

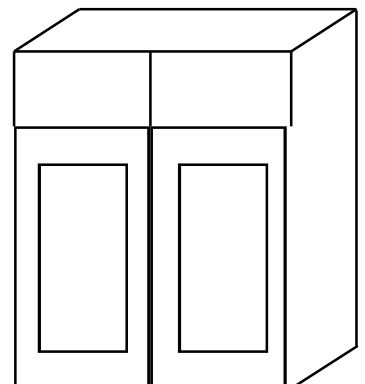



Product Description

23330 Harborview Road
Punta Gorda, FL 33980
Phone 941-875-9900

Under Grill Access Doors

Single access door

Cut out for wall will be 1 1/2 (+/- 1/4) inch less than outside dimension of door ordered

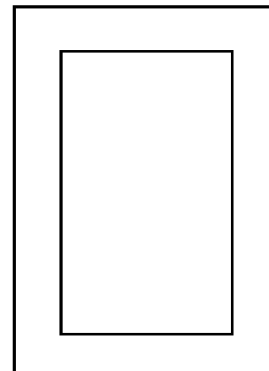

Double Access Doors

Cut out for wall will be 1 1/2 (+/- 1/4) inch less than outside dimension of door ordered

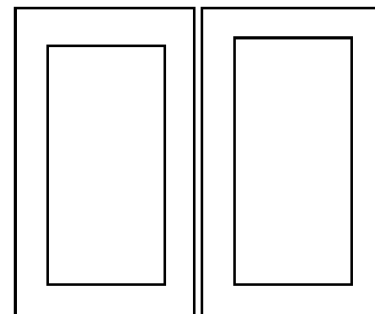

Drawer Banks

Cut out for wall will be 1 1/2 (+/- 1/4) inch less than outside dimension of door ordered and 23 inches from front of door to back of cabinet

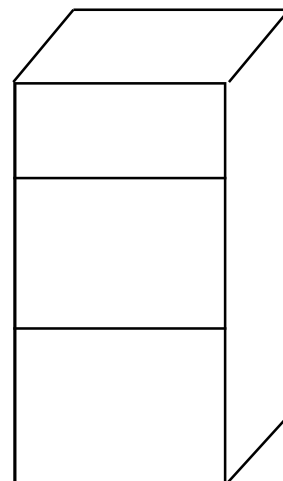



Product Description

23330 Harborview road
Punta Gorda, FL 33980
Phone 941-875-9900

Decorative hood covers and chimney stacks



Hoods and chimney stack are to cover actual working vents and plumbing They **DO NOT** include any electrical, fans or pipes for actual venting. When ordering we will need the actual vent being used or exact measurements to ensure a proper fit.

All hoods and chimneys are constructed from powder coated aluminum and covered with Ipe and choice of metal insert.

Vents and chimneys are charged by the lineal foot.

Hoods are priced 4 foot tall or less

Chimneys are priced 4 foot or less

Clipped corners are an addition charge

Custom Cabinet Order Form

Phone 941-875-9900

Customer Name:_____ **Contact Number:**_____

P.O. _____ Fax Number: _____

Lift Gate ☐

Display order ☐

☐

Wood Species _____

Custom orders will be priced within 72 hours and will take 6 to 8 weeks to ship.





Lifestyle Outdoor Cabinets

Sales Rep: _____

23330 Harborview rd.
Punta Gorda, FL 33980

Dealer Registration

Phone 941-875-9900

Fax 941-505-0605

Name: _____

Company Name: _____

Position: _____

Mailing address _____

Phone Number: (____) _____

Cell Number: (____) _____

Email: _____

Phone Number: (____) _____

Years in Business: _____

Fax Number: (____) _____

Design software used: _____

Email: _____

Annual sales: _____

Web site: _____

Estimated annual purchases: _____

Shipping Address: Same as above ☐

Number of sales staff: _____

Sets of Sample Doors: _____

Minimum 1 set

Please check one:

☐ Outdoor kitchen contractor

☐ Remodeler

☐ Cabinet company

☐ GC/Builder

☐ Other: _____

Order Contact: _____

Order contact email: _____

Billing contact: _____

Billing contact email: _____

Trade References

1) Name _____	Acct.# _____	Contact _____
Addr. _____	City _____	State _____ Zip _____ Tel. _____
2) Name _____	Acct.# _____	Contact _____
Addr. _____	City _____	State _____ Zip _____ Tel. _____
3) Name _____	Acct.# _____	Contact _____
Addr. _____	City _____	State _____ Zip _____ Tel. _____

THE UNDERSIGNED AGREES THAT HE/SHE SHALL PAY FOR ALL OUTSTANDING BALANCES PER TERMS AS AGREED BETWEEN BOTH PARTIES. IN THE EVENT THIS ACCOUNT IS REFERRED TO ANY ATTORNEY FOR COLLECTION, THE PARTIES AGREE THAT AN ADDITIONAL TWENTY-FIVE (25%) OF THE OUTSTANDING BALANCE DUE WILL BE PAID AS ATTORNEY'S FEES.

Auth. Signature _____ (Print Name) _____ Title: _____ Date: _____

Lifestyle Outdoor Cabinets Lifetime Limited Warranty

Lifestyle Outdoor Cabinets warrants to the original consumer purchaser that all aluminum powder coated parts and cabinet structure will be free from defects in material and workmanship under normal use for your lifetime as long as you own the cabinetry. This warranty is not transferable. No changes or modifications can be made to this warranty except by an officer of Lifestyle Outdoor Cabinets, LLC Lifestyle Outdoor Cabinets LLC may elect to repair or replace any defective product covered by our warranty. Our warranty does not cover defects caused by misuse, abuse, negligence, alterations, environmental conditions, improper installation, storage and handling, nor any labor expenses.

Lifestyle Outdoor Cabinets 5 Year Warranty

As with other natural materials, wood is affected by environmental factors such as natural and artificial lighting. Darkening or mellowing of the wood can be expected and is a natural process of wood as it ages. Variations in color and characteristics are not considered imperfections or defects. This warranty does not cover the natural aging, darkening or drying of wood nor does it apply to the inherent growth characteristics of wood. We further provide a 5 YEAR WARRANTY to the original purchaser on the door hinges and drawer glides. This 5 YEAR WARRANTY provides that the door hinges and drawer glides will be free from defects in material and workmanship under normal use. Replacement parts are subject to their availability from our suppliers. Lifestyle Outdoor Cabinets LLC may elect to repair or replace any defective product covered by our warranty. Our warranty does not cover defects caused by misuse, abuse, negligence, alterations, environmental conditions, improper installation, storage and handling, nor any labor expenses. From time to time, we will change design, specifications, and materials as conditions require and improvements are developed, but we have no obligation to incorporate such changes in products we previously manufactured. TO THE EXTENT PERMITTED BY LAW, ANY IMPLIED WARRANTIES, INCLUDING THE IMPLIED WARRANTIES OF MERCHANTABILITY AND FITNESS FOR A PARTICULAR PURPOSE, ARE LIMITED TO THE DURATION OF THIS EXPRESS WARRANTY. Some provinces and some states do not allow limitations on how long an implied warranty lasts, so the above limitation or exclusion may not apply to you. THIS WARRANTY EXCLUDES ANY INCIDENTAL OR CONSEQUENTIAL DAMAGES. Some provinces and some states do not allow the exclusion or limitation of incidental or consequential damages, so the above limitation or exclusion may not apply to you. This warranty is valid in the United States of America. This warranty gives you specific legal rights, and you may also have other rights that vary from state to state.

To obtain performance under this warranty, the purchaser must contact the Lifestyle Outdoor Cabinets supplier and report, in writing, all defects claimed and provide the original sales receipt or other documentation acceptable to Lifestyle Outdoor Cabinets LLC. If you have difficulty obtaining assistance, write to: Lifestyle Outdoor Cabinets LLC, 23330 Harborview Road, Punta Gorda, FL 33980

Description	Price	Fillers and Panels	
Full height Door Cabinets FHD24, FHD27	\$800.00 per lineal foot Minimum \$1000.00	BF330	\$65.00
False drawer fronts and sink bases SB24, SB27	\$800.00 per lineal foot Minimum \$1000.00	BF530	\$77.00
Base cabinets working drawer B24, B27	\$850.00 per lineal foot Minimum \$1000.00	BF336	\$76.00
Base cabinets 2 drawer 2 door BDD24, BDD27	\$850.00 per lineal foot Minimum \$1000.00	BF536	\$85.00
BBR/BBL	\$800.00 per lineal foot	BF342	\$87.00
BDC24	\$2200.00 Each	BF542	\$97.00
BDC27	\$2350.00 Each	DF30	\$94.00
DIB4524	\$2200.00 Each	TK8 **	\$138.00
DIB4527	\$2350.00 Each	T30	\$65.00
Drawer Banks	\$850.00 per lineal Plus additional drawer charge of \$150.00 each drawer	T42	\$87.00
Wall Cabinets	\$700.00 per lineal foot	T96	\$138.00
WDC30	\$2200.00 Each	FEP	\$250 per Lineal foot
WDC36	\$2350.00 Each	FMP	\$250 Per Lineal Foot
WDC42	\$2400.00 Each	FBP30	\$250 per Lineal foot
Grill Cabinets	\$850.00 per lineal foot	FBP36	\$275 Per Lineal Foot
SG48	\$5000.00 Each	FBP42	\$300 per Lineal foot
SG72	\$7500.00 Each	FMP30	\$250 per Lineal foot
SGR72	\$7500.00 Each	FMP36	\$275 Per Lineal Foot
SG96	\$10,000.00 each	FMP42	\$300 per Lineal foot
SGR96	\$9600.00 each	Hoods	\$750 Per Lineal Foot
Access doors	\$350.00 Per Lineal Foot	Chimney Stack	500 Per Lineal Foot
Access Doors with Drawers	\$700.00 Per Lineal Foot	Clipped Corners	\$350.00 each
Access Drawer Banks	750.00 per lineal Plus additional drawer charge of \$150.00 each drawer	**	All base cabinets include required toe kick in price

